

ELLIS LAWRENCE BUILDING INVENTORY

HISTORIC NAME: BELLE COURT APARTMENTS

ASSOCIATED STRUCTURES:

SETTING:

Urban, multi-family residential; located in Nob Hill area of NW Ptld. one blk. from Burnside St. & commercial area, Trinity Episcopal Church is to the north.

SIGNIFICANCE OF LAWRENCE FIRM'S DESIGN:

EXTER.DETAILS/CRAFTSMANSHIP: High-quality skilled work: some fine materials.

INTER.DETAILS/CRAFTSMANSHIP: High-quality skilled work: some fine materials.

EXTERIOR INTEGRITY: Essentially intact as originally built.

INTERIOR INTEGRITY: Minor changes, but original character intact.

SITE INTEGRITY: Essentially intact as originally built.

SETTING INTEGR: Historic character & relationship of surroundings is intact.

SIGNIFICANCE STATEMENT:

Listed on the National Register of Historic Places in 1986. Also Portland Historical Landmark in 1986. The developers of the Belle Court Apts. were Fred A. Jacobs & Harry Beckwith. Both men had fled the San Francisco area after the earthquake of 1906. Belle Court is significant as one of the early apt. complexes designed for "affluent city dwellers". Belle Court is located on a large 200'X 400' block. The undeveloped lot to the south was to be the site of a second unit of Belle Court apts. (designed by Lawrence & Holford), the unit was never built. Lot was originally owned by Trinity Episcopal Church, Harry Beckwith a member of this church. Belle Court apts. are an example of the Jacobethan style, a style used infrequently by Lawrence.

SOURCES/DOCUMENTS: Description (Location)

Exhibit Quality Photos, E. Lawrence Collection/U of O Special Collections; Multnomah County Tax Assessor Records;

Polk's Portland City Directory; Portland Building Permits; Oregon Historic Photo Collection (OHS);

National Register Nomination prepared by E. O'Brien & Melissa Cole; Original blueprints at Oregon Historical Society;

Portland Historic Resource Inventory;

Exhibit Quality Photos, Angelus Collection/U of O Special Coll.

PUBLICATIONS:

PORTLAND DAILY ABSTRACT. 4/21/12, 6/6/12, 2/12/13, 9/6/13. PACIFIC COAST ARCH. 2/1913.PACIFIC BUILDER AND ENGINEER. 4/13/12, 5/18/12, 3/1/13, 9/13/13.

SLIDE NO.:

RESEARCH BY: P. Sackett

DATE: 03/15/88

SHPO INVENTORY NO.:

RECORDED BY: K. Lakin

DATE: 09/14/88

ELLIS LAWRENCE BUILDING SURVEY
HISTORIC NAME: BELLE COURT APARTMENTS

RECENT PHOTO
NEGATIVE #s:
PSR 1, #4

First # above
is upper-right
photo; second #
is just below.
If no # above,
see sources at
bottom of page.

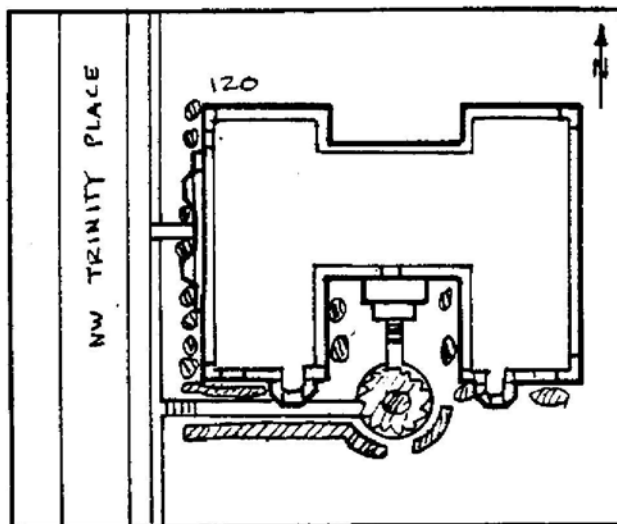
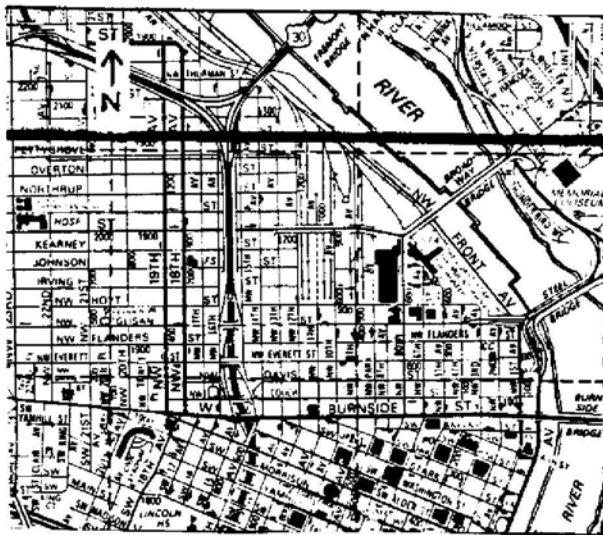

HISTORIC PHOTO/OTHER GRAPHIC SOURCE: P. Sackett and S. Donovan
Lawrence Col. photos (UO Library)

OREGON INVENTORY OF HISTORIC PROPERTY
ELLIS LAWRENCE BUILDING INVENTORY

EVALUATION

HISTORIC NAME: BELLE COURT APARTMENTS

| <u>INTEGRITY OF:</u> | <u>NUMERICAL</u> |
|--|------------------|
| 1. EXTERIOR: Essentially intact as originally built. | 9 |
| 2. INTERIOR: Minor changes, but original character intact. | 7 |
| 3. SITE: Essentially intact as originally built. | 9 |
| 4. SETTING: Historic character & relationship of surroundings is intact. | 5 |

INTEGRITY TOTAL 30

| <u>DISTINCTION OF:</u> | |
|---|-------------|
| 1. EXTERIOR DETAILS & CRAFTSMANSHIP: High-quality skilled work: some fine materials. | 7 |
| 2. INTERIOR DETAILS & CRAFTSMANSHIP: High-quality skilled work: some fine materials. | 7 |
| 3. STYLE: (Jacobethan) It is a prime example of its identified style. Compared to Lawrence's other surviving Oregon buildings, this style is unique in its city/town or rural area. | 5 5 |
| 4. ORIGINAL USE: (residence/apartment) Compared to Lawrence's other surviving Oregon buildings, this use is one of few (5 or less) in its city/town or rural area. | 2 |
| 5. ARCHITECTURAL DESIGN: Compared to Lawrence's other surviving Oregon buildings, this design is above average quality and significance. Is it part of an ensemble of surviving buildings by Lawrence? No other Lawrence buildings are nearby. Are structural or technical aspects of the design significant? Of moderate significance. | 5 0 5 |
| 6. LAWRENCE'S PERSONAL INVOLVEMENT IN THE DESIGN PROCESS: Lawrence was probably chief designer, though little evidence | 6 |

DISTINCTION TOTAL 40

EDUCATIVE OR ASSOCIATIVE VALUE:

| | |
|--|---|
| 1. HISTORIC EVENTS OR ACTIVITIES: No known association with historic events or activities. | 0 |
| 2. HISTORIC PERSONS: No known association with a significant historic person. | 0 |
| 3. SYMBOLIC ASSOCIATION WITH AN IDEAL, INSTITUTION, OR POLITICAL ENTITY: No known significant symbolic association. | 0 |

EDUCATIVE OR ASSOCIATIVE TOTAL 0

GRAND TOTAL 70

RANK: PRIMARY

NOTE: Only the built, surviving buildings in Oregon were evaluated.