

OREGON INVENTORY OF HISTORIC PROPERTY
ELLIS LAWRENCE BUILDING INVENTORY
COUNTY: Klamath

HISTORIC NAME: ST. PAUL'S EPISCOPAL CHURCH

COMMON NAME:
OTHER NAMES: The "Friendly Church"

RESOURCE TYPE: Building
STATUS: built & survives
LAWRENCE

CITY: Klamath Falls Oregon
STREET: 801 Jefferson
OWNER: St. Paul's Episcopal Ch.
805 Jefferson

(JOB#) YEAR: (1747) 1925
(JOB#) YEAR: (1792) 1926
(JOB#) YEAR: ()
FIRST DATE: Nov. 1924
DESIGN BEG: 1925
DESIGN END: Aug. 1925
CONSTR BEG: Nov. 1925
CONSTR END: Jan. 1926
LOSS DATE:
ORIGINAL USE: Church
PRESENT USE: Church
SITE: 0.4 acres, approx.

TOWNSHIP: 38S RANGE: 09E SECTION: 29
MAP#: 38-09-29DC TAX LOT: 38-09-29-01-6800
ADDITION: Nichol's Addition ORIGINAL USE:
BLOCK: 056 LOT: 3 QUAD: PRESENT USE:
ASSESSOR #:

THEMES: 20C Architecture, Religion

DATA BELOW IS ON LAWRENCE FIRM'S DESIGN AS-BUILT:

ARCHITECT: Lawrence and Holford
ENGINEERS & CONSULTANTS:

CHIEF DESIGNER: Wm Holford

CONTRACTORS:

W.D. Miller (Construction); Industrial (Electric); Francis R. Olds (Painting);
Walter Pomeroy (Plastering), (all are from Klamath Falls)

ARTISTS & CRAFTSMEN:

STYLE: Arts & Crafts

PLAN TYPE/SHAPE: rectangular (sides long)

FOUNDATION MATERIAL: concrete

STORIES: 1.5 BASEMENT: yes

ROOF/MATERIAL: hipped gable w/wall dormer(s)/Wood shingles

WALL CONSTR: nailed wood frame

STRUC.FRAME: nailed wood frame

PRIME WINDOW TYPE: wood group. single-pane casemt w/special Gothic

EXTERIOR SURFACE MATERIAL: wood shingles,

DECORATIVE FEATURES/MATERIALS:

flared shingled skirt, wooden cross

OTHER:

Sanctuary alterations: chancel mural by Rev. Frederick Wissenbach, 1949-50;
stained glass (1954); organ grille rebuilt (1947); chancel acous. tile added.

CONDITION: good

MOVED: not moved

ALTERATIONS/ADDITIONS (dated):

Front entrance moved & stone added, E dormer removed, wing added, (all 1949), &
Swanson Hall wing (1960), all by H. Perrin; west entrance by Nina Pence (1986).

LANDSCAPE FEATURES:

3 mature elm trees on 8th street side.

ELLIS LAWRENCE BUILDING INVENTORY

HISTORIC NAME: ST. PAUL'S EPISCOPAL CHURCH

ASSOCIATED STRUCTURES:

none

SETTING:

peripheral urban

SIGNIFICANCE OF LAWRENCE FIRM'S DESIGN:

EXTER.DETAILS/CRAFTSMANSHIP: Better than average workmanship and materials.

INTER.DETAILS/CRAFTSMANSHIP: Better than average workmanship and materials.

EXTERIOR INTEGRITY: Moderate changes; some original character remains.

INTERIOR INTEGRITY: Minor changes, but original character intact.

SITE INTEGRITY: Moderate changes; some original character remains.

SETTING INTEGR: Major changes to character and relationship of surroundings.

SIGNIFICANCE STATEMENT:

St. Paul's is relatively intact. The interior particularly retains its integrity and was possibly influenced by Nevius's design for St. Paul's in The Dalles (1875) where Lawrence's partner William Holford designed a Parish House shortly prior to this project. The original designs indicate compromises made mostly in the number of dormers and front entry location, in apparent attempts at cost reduction. According to the opening announcement the model for this project was a "historic parish church of England". All the major additions were by Howard R. Perrin, a prominent Klamath Falls architect from 1922-69. He was the designer of many commercial structures in downtown Klamath Falls, plus works for the armed forces at Camp White, and Klamath and Lakeview Naval Air Stations. It is probable that Perrin was the on-site architect for the original Holford construction. No other association between Lawrence firms and Perrin is known.

SOURCES/DOCUMENTS: Description (Location)

Blueprints of original design, Aug. 1925 (Eastern Oregon Episcopal Diocese, The Dalles)

Blueprints/plans, post 1947 (at Owner address and Klamath Falls Building Exchange)

KLAMATH FALLS EVENING HERALD, 10-24-25, 11-14-25, 12-21-25, 1-23-25
Historic Photo (Oregon Historic Society #010495)

Episcopal Church, K. Falls 9-25-53, and A Parish History 1-1983 (file)

SANBORN FIRE MAP, rev. Aug. 1927 p.8 (UO Map Library)

Tax records, sht. 3809-29DC-16800, code key 760723 (K. Falls Courthouse)_

PUBLICATIONS:

PACIFIC BUILDER & ENGINEER 8/29/25 p5 "Plans completed..."

DAILY JOURNAL OF COMMERCE, 12/4/45 p1.

SLIDE NO.:

SHPO INVENTORY NO.:

RESEARCH BY: G. Kramer

RECORDED BY: M. Shellenbarger

DATE: 12/03/87

DATE: 12/25/87

ELLIS LAWRENCE BUILDING SURVEY

HISTORIC NAME: ST. PAUL'S EPISCOPAL CHURCH

RECENT PHOTO
NEGATIVE #s:
MS2-6

*First # above
is upper-right
photo; second #
is just below.
If no # above,
see sources at
bottom of page.*

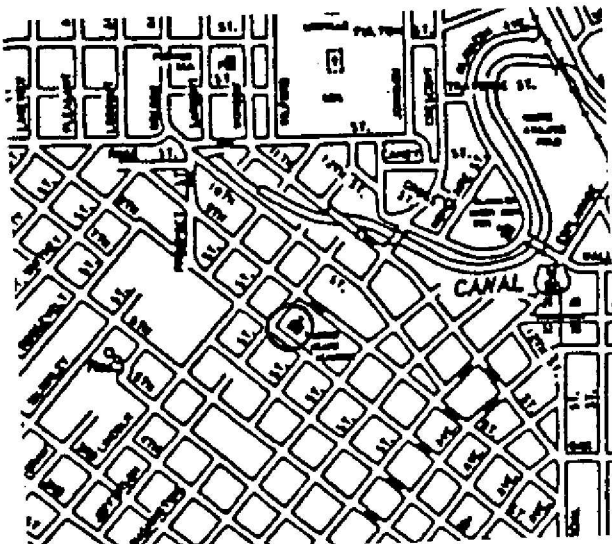

EIGHTH STREET

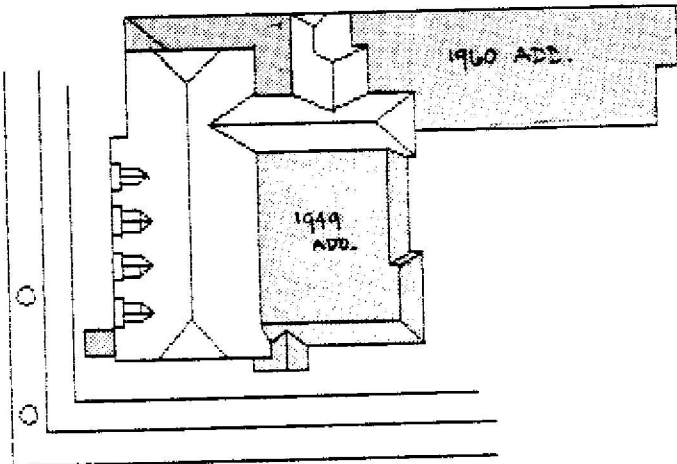

JEFFERSON STREET

St. Paul's Episcopal Church, Klamath Falls

HISTORIC PHOTO/OTHER GRAPHIC SOURCE: Lawrence Col. photos, UO Library

OREGON INVENTORY OF HISTORIC PROPERTY
ELLIS LAWRENCE BUILDING INVENTORY

E V A L U A T I O N

HISTORIC NAME: ST. PAUL'S EPISCOPAL CHURCH

INTEGRITY OF:

	<u>NUMERICAL</u>
1. EXTERIOR: Moderate changes; some original character remains.	3
2. INTERIOR: Minor changes, but original character intact.	7
3. SITE: Moderate changes; some original character remains.	3
4. SETTING: Major changes to character and relationship of surroundings.	0

INTEGRITY TOTAL 13

DISTINCTION OF:

1. EXTERIOR DETAILS & CRAFTSMANSHIP: Better than average workmanship and materials.	3
2. INTERIOR DETAILS & CRAFTSMANSHIP: Better than average workmanship and materials.	3
3. STYLE: (Arts & Crafts) It has distinctive features of its identified style.	2
Compared to Lawrence's other surviving Oregon buildings, this style is unique in its city/town or rural area.	5
4. ORIGINAL USE: (Church) Compared to Lawrence's other surviving Oregon buildings, this use is unique in its city/town or rural area.	5
5. ARCHITECTURAL DESIGN: Compared to Lawrence's other surviving Oregon buildings, this design is average quality and significance.	2
Is it part of an ensemble of surviving buildings by Lawrence? No other Lawrence buildings are nearby.	0
Are structural or technical aspects of the design significant? Of little significance.	0
6. LAWRENCE'S PERSONAL INVOLVEMENT IN THE DESIGN PROCESS: Another designer is known to have been chief designer.	0

DISTINCTION TOTAL 20

EDUCATIVE OR ASSOCIATIVE VALUE:

1. HISTORIC EVENTS OR ACTIVITIES: Some association with historic events or activities.	2
2. HISTORIC PERSONS: Some association with significant historic person(s).	2
3. SYMBOLIC ASSOCIATION WITH AN IDEAL, INSTITUTION, OR POLITICAL ENTITY: Major symbolic association with local ideal or institution.	5

EDUCATIVE OR ASSOCIATIVE TOTAL 9

GRAND TOTAL 42

RANK: SECONDARY

NOTE: Only the built, surviving buildings in Oregon were evaluated.