

OREGON INVENTORY OF HISTORIC PROPERTY  
ELLIS LAWRENCE BUILDING INVENTORY  
COUNTY: Lane

HISTORIC NAME: CHAMBERS, FRED E., HOUSE

COMMON NAME:		RESOURCE TYPE: Building
OTHER NAMES: Danby house		STATUS: built & survives
		<u>LAWRENCE</u>
		(JOB#) YEAR: (1651) 1923
		(JOB#) YEAR: ( )
		(JOB#) YEAR: ( )
CITY: vicinity Eugene	Oregon	FIRST DATE: May 1923
STREET: 1151 Irving Road, Santa Clara		DESIGN BEG: May 1923
OWNER: Danby, Jack E. & Anne		DESIGN END: ? 1923
(at property address above)		CONSTR BEG: ? 1923
TOWNSHIP: 17S RANGE: 04W SECTION: 10		CONSTR END:
MAP#: TAX LOT: 17-04-10-00-2900		LOSS DATE:
ADDITION:	ORIGINAL USE: residence	
BLOCK: LOT: QUAD:	PRESENT USE: residence	
ASSESSOR #:	SITE: 2.0 acres, approx.	
THEMES: 20C Architecture		

DATA BELOW IS ON LAWRENCE FIRM'S DESIGN AS-BUILT:

ARCHITECT: Lawrence and Holford CHIEF DESIGNER: probably EFL  
ENGINEERS & CONSULTANTS:

CONTRACTORS:

ARTISTS & CRAFTSMEN:

STYLE: Colonial (1910-1935)  
PLAN TYPE/SHAPE: "L"-shaped +irregular/diagonal wing  
FOUNDATION MATERIAL: concrete STORIES: 2 BASEMENT: yes  
ROOF/MATERIAL: hipped w/center gable w/hipped dormer(s)/Wood shingles  
WALL CONSTR: nailed wood frame STRUC.FRAME: nailed wood frame  
PRIME WINDOW TYPE: wood multi-pane double-hung  
EXTERIOR SURFACE MATERIAL: wood bevel siding,  
DECORATIVE FEATURES/MATERIALS:  
leaded glass window in livingroom; porte cochere; enclosed patio in rear

OTHER:

CONDITION: good  
MOVED: not moved  
ALTERATIONS/ADDITIONS (dated):  
kitchen remodeled (c1957); upper maid chambers opened to rest of upper floor  
(c1957); composition shingles ( ? ); aluminum storm windows ( ? )  
LANDSCAPE FEATURES:  
house on 6' earth platform, raising it above the river plane; extensively  
landscaped with trees & shrubbery; formal rose garden in rear (now removed)

## ELLIS LAWRENCE BUILDING INVENTORY

**HISTORIC NAME:** CHAMBERS, FRED E., HOUSE

### ASSOCIATED STRUCTURES:

#### SETTING:

flat rural farmland and orchards now just past the northern edge of the Eugene metropolitan area

#### SIGNIFICANCE OF LAWRENCE FIRM'S DESIGN:

**EXTER.DETAILS/CRAFTSMANSHIP:** Better than average workmanship and materials.

**INTER.DETAILS/CRAFTSMANSHIP:** Ordinary construction with no special features.

**EXTERIOR INTEGRITY:** Minor changes, but original character intact.

**INTERIOR INTEGRITY:** Minor changes, but original character intact.

**SITE INTEGRITY:** Minor changes, but original character intact.

**SETTING INTEGR:** Historic character & relationship of surroundings is intact.

#### SIGNIFICANCE STATEMENT:

Fred E. Chambers was an important developer of the fruit industry in Eugene, and his orchards adjoined this house. This country home was raised above the floor plane on a six-foot platform of dirt delivered to the site from the excavation for the downtown Eugene Montgomery Ward Store (now Lane Community College). Fred Chambers probably knew of Lawrence through his brother Frank, whose sister-in-law was Maude Kerns - a faculty member in Lawrence's School of Architecture and Allied Arts. The home is large but quite simple in detail, apparently at Fred Chambers' request. It is formal in front and informal in the rear - a characteristic of many of Lawrence's houses. The present owner is only the 2nd owner of the house, and they have maintained the house in near-original condition. It is the largest of six Eugene-area houses known to have been designed by Lawrence or his firms, and it is his only country house. Four of these houses still stand.

#### SOURCES/DOCUMENTS: Description (Location)

bill for architectural services, box 6 of EF Lawrence Collection (UO Library, Special Collections)

blueprints of elevations (at house, possession of owner); other blueprints may also exist at the house.

Frank Chambers & Chambers Hardware Co. Files, (Lane County Historical Museum)

POLK'S EUGENE CITY & LANE COUNTY DIRECTORIES

#### PUBLICATIONS:

SLIDE NO.:

SHPO INVENTORY NO.:

RESEARCH BY: B. Crawford

RECORDED BY: M. Shellenbarger

DATE: 08/17/88

DATE: 08/17/88

ELLIS LAWRENCE BUILDING SURVEY

HISTORIC NAME: CHAMBERS, FRED E., HOUSE

RECENT PHOTO  
NEGATIVE #s:  
MS4-25

*First # above  
is upper-right  
photo; second #  
is just below.  
If no # above,  
see sources at  
bottom of page.*

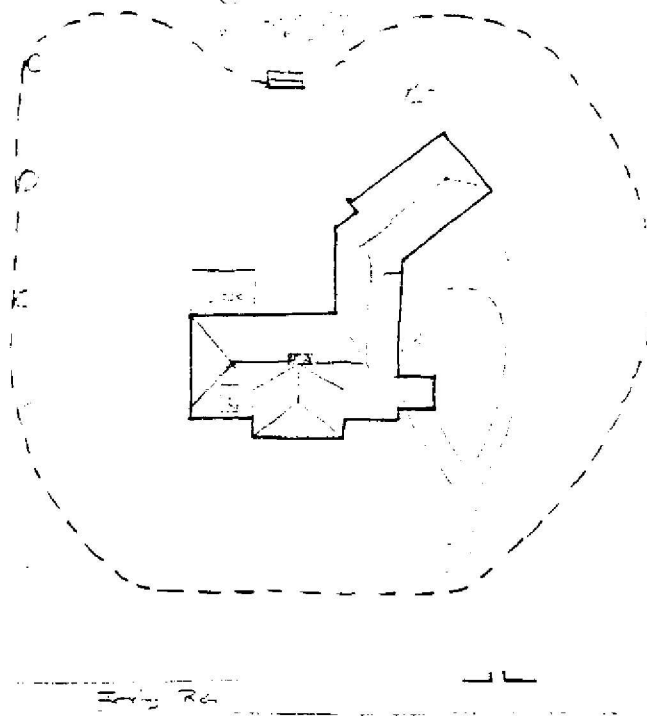
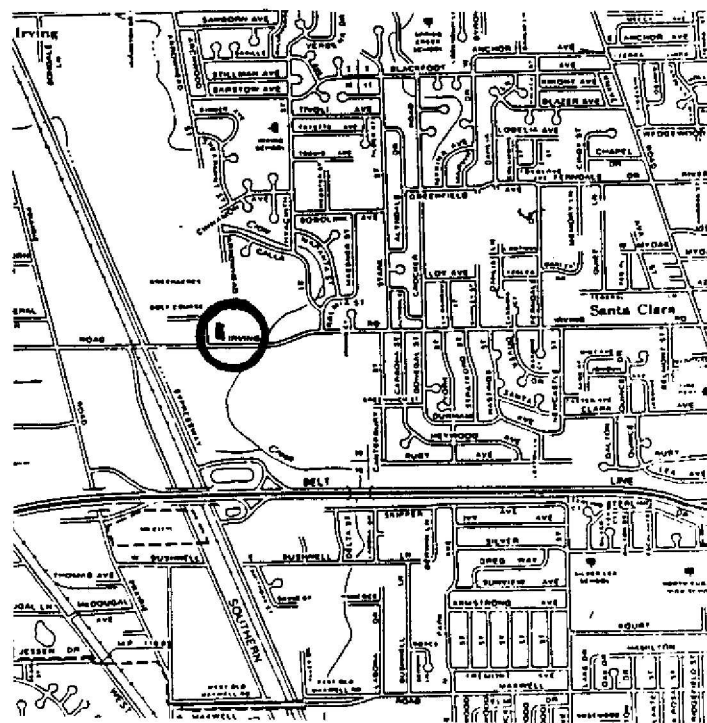

HISTORIC PHOTO/OTHER GRAPHIC SOURCE:

**OREGON INVENTORY OF HISTORIC PROPERTY  
ELLIS LAWRENCE BUILDING INVENTORY**

**EVALUATION**

**HISTORIC NAME: CHAMBERS, FRED E., HOUSE**

<u>INTEGRITY OF:</u>	<u>NUMERICAL</u>
1. <b>EXTERIOR:</b> Minor changes, but original character intact.	7
2. <b>INTERIOR:</b> Minor changes, but original character intact.	7
3. <b>SITE:</b> Minor changes, but original character intact.	7
4. <b>SETTING:</b> Historic character & relationship of surroundings is intact.	5
<b>INTEGRITY TOTAL</b>	<b>26</b>

<u>DISTINCTION OF:</u>	
1. <b>EXTERIOR DETAILS &amp; CRAFTSMANSHIP:</b> Better than average workmanship and materials.	3
2. <b>INTERIOR DETAILS &amp; CRAFTSMANSHIP:</b> Ordinary construction with no special features.	0
3. <b>STYLE:</b> (Colonial (1910-1935)) It has distinctive features of its identified style. Compared to Lawrence's other surviving Oregon buildings, this style is one of few (5 or less) in its city/town or rural area.	2
4. <b>ORIGINAL USE:</b> (residence) Compared to Lawrence's other surviving Oregon buildings, this use is one of few (5 or less) in its city/town or rural area.	2
5. <b>ARCHITECTURAL DESIGN:</b> Compared to Lawrence's other surviving Oregon buildings, this design is average quality and significance. Is it part of an ensemble of surviving buildings by Lawrence? No other Lawrence buildings are nearby. Are structural or technical aspects of the design significant? Of little significance.	2
6. <b>LAWRENCE'S PERSONAL INVOLVEMENT IN THE DESIGN PROCESS:</b> Lawrence was probably chief designer, though little evidence	6
<b>DISTINCTION TOTAL</b>	<b>17</b>

<u>EDUCATIVE OR ASSOCIATIVE VALUE:</u>	
1. <b>HISTORIC EVENTS OR ACTIVITIES:</b> No known association with historic events or activities.	0
2. <b>HISTORIC PERSONS:</b> Strong assoc. with person(s) of local historic significance.	5
3. <b>SYMBOLIC ASSOCIATION WITH AN IDEAL, INSTITUTION, OR POLITICAL ENTITY:</b> No known significant symbolic association.	0
<b>EDUCATIVE OR ASSOCIATIVE TOTAL</b>	<b>5</b>

**GRAND TOTAL            48**

**RANK:                    SECONDARY**

*NOTE: Only the built, surviving buildings in Oregon were evaluated.*