

OREGON INVENTORY OF HISTORIC PROPERTY
ELLIS LAWRENCE BUILDING INVENTORY
COUNTY: Deschutes

HISTORIC NAME: HAMMOND, ROSS B., RANCH HOUSE

COMMON NAME: Pine Meadow Ranch
OTHER NAMES:

RESOURCE TYPE: Building
STATUS: built & survives

LAWRENCE
(JOB#) YEAR: () 1936
(JOB#) YEAR: ()
(JOB#) YEAR: ()

FIRST DATE:
DESIGN BEG:
DESIGN END:
CONSTR BEG:
CONSTR END: ? 1936

LOSS DATE:
ORIGINAL USE: residence
PRESENT USE: residence
SITE: 0.1 acres, approx.

CITY: Sisters Oregon

STREET: 15619 Sisters View Dr.

OWNER: Sokol, Dorro
PO Box 96 Sisters, OR 97759

TOWNSHIP: 15S RANGE: 10E SECTION: 09

MAP#: 15-10-9 TAX LOT: 15-10-09-00-0900

ADDITION: ORIGINAL USE: residence

BLOCK: LOT: QUAD: PRESENT USE: residence

ASSESSOR #:

THEMES: 20C Architecture, Stock Raising

DATA BELOW IS ON LAWRENCE FIRM'S DESIGN AS-BUILT:

ARCHITECT: Lawrence, Holford & Allyn
ENGINEERS & CONSULTANTS:

CHIEF DESIGNER: probably EFL

CONTRACTORS:

Ross Hammond (general)

ARTISTS & CRAFTSMEN:

STYLE: National Park

PLAN TYPE/SHAPE: rectangular (front long) +irregular/diagonal wing

FOUNDATION MATERIAL: concrete STORIES: 2 BASEMENT: yes

ROOF/MATERIAL: med. gable (10/12 max.) w/gable wing/

WALL CONSTR: nailed wood frame STRUC.FRAME: nailed wood frame

PRIME WINDOW TYPE: steel group.multi-pane casement w/special bay/oriel

EXTERIOR SURFACE MATERIAL: wood shingles, wood vertical board

DECORATIVE FEATURES/MATERIALS:

living room rough hewn wood beams, fireplace which had brick surround with flat arch and molded wood mantel; vertical board, knotty pine paneling on interior

OTHER:

Total of six fireplaces. 2nd floor west deck added (c.1972); many windows altered (1969-70)

CONDITION: good

MOVED: not moved

ALTERATIONS/ADDITIONS (dated):

living room fireplace refaced with stone (1969); kitchen & baths remodeled (1969-70); carport addition (1972); orig. garage altered to family room (1972)

LANDSCAPE FEATURES:

Squaw creek brook runs along east side of home site, several large ponderosa pines surround home; swimming pool added (1972)

ELLIS LAWRENCE BUILDING INVENTORY

HISTORIC NAME: HAMMOND, ROSS B., RANCH HOUSE

ASSOCIATED STRUCTURES:

round barn (built by Hammond); cabin; bunk house

SETTING:

flat ranch land with dramatic view of the Cascade Mountains, approximately .5 miles from the town of Sisters

SIGNIFICANCE OF LAWRENCE FIRM'S DESIGN:

EXTER.DETAILS/CRAFTSMANSHIP: Ordinary construction with no special features.

INTER.DETAILS/CRAFTSMANSHIP: Better than average workmanship and materials.

EXTERIOR INTEGRITY: Moderate changes; some original character remains.

INTERIOR INTEGRITY: Moderate changes; some original character remains.

SITE INTEGRITY: Minor changes, but original character intact.

SETTING INTEGR: Minor changes to character and relationship of surroundings.

SIGNIFICANCE STATEMENT:

Ross Hammond was the general contractor for some of Lawrence's most important buildings on the University of Oregon campus, including the Museum of Art and Library. Hammond was also the general contractor for the Oregon State Capitol building in Salem. This home was constructed in order to provide work for some of Hammond's key workers during the slack years of the depression. Bill Hammond, son of Ross Hammond, owned the house until 1972; it has changed ownership twice since 1972. The extraordinary setting and the relatively intact nature of the house in its setting are significant. This is one of only four known built "ranch" houses designed by Lawrence. (The others are the Henry McCall house near Redmond, Lawrence's own Apple Ranch house in Odell, and the Thompson house near Heppner.)

SOURCES/DOCUMENTS: Description (Location)

photo of rendering in E.F. Lawrence Collection (UO Library, Special Coll.)

Hammond, William, phone interview by Don Rich, 12/2/87.

Sokol, Dorro, interview by Don Rich & M. Shellenbarger, March 1988

PUBLICATIONS:

SLIDE NO.:

SHPO INVENTORY NO.:

RESEARCH BY: MS/ D. Rich

RECORDED BY: M. Shellenbarger

DATE: 03/21/88

DATE: 06/28/88

ELLIS LAWRENCE BUILDING SURVEY
HISTORIC NAME: HAMMOND, ROSS B., RANCH HOUSE

RECENT PHOTO
 NEGATIVE #s:
 MS1-4A

*First # above
 is upper-right
 photo; second #
 is just below.
 If no # above,
 see sources at
 bottom of page.*

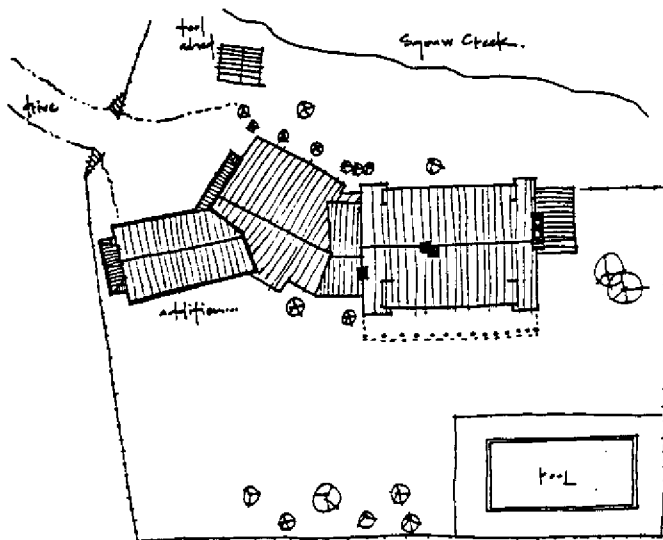
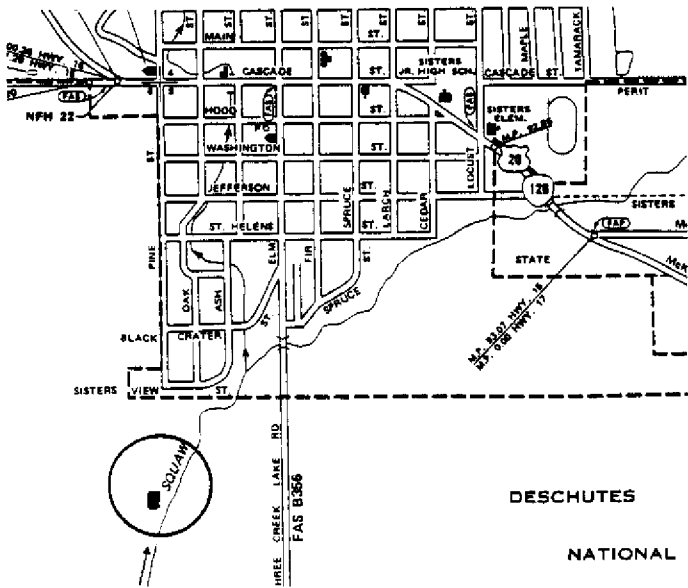

HISTORIC PHOTO/OTHER GRAPHIC SOURCE:

**OREGON INVENTORY OF HISTORIC PROPERTY
ELLIS LAWRENCE BUILDING INVENTORY**

E V A L U A T I O N

HISTORIC NAME: HAMMOND, ROSS B., RANCH HOUSE

<u>INTEGRITY OF:</u>	<u>NUMERICAL</u>
1. EXTERIOR: Moderate changes; some original character remains.	3
2. INTERIOR: Moderate changes; some original character remains.	3
3. SITE: Minor changes, but original character intact.	7
4. SETTING: Minor changes to character and relationship of surroundings.	3
INTEGRITY TOTAL	16

<u>DISTINCTION OF:</u>	
1. EXTERIOR DETAILS & CRAFTSMANSHIP: Ordinary construction with no special features.	0
2. INTERIOR DETAILS & CRAFTSMANSHIP: Better than average workmanship and materials.	3
3. STYLE: (National Park) It has few features associated with its identified style. Compared to Lawrence's other surviving Oregon buildings, this style is unique in its city/town or rural area; one of few in Oregon.	0 7
4. ORIGINAL USE: (residence / ranch house) Compared to Lawrence's other surviving Oregon buildings, this use is unique in its city/town or rural area; one of few in Oregon	7
5. ARCHITECTURAL DESIGN: Compared to Lawrence's other surviving Oregon buildings, this design is average quality and significance. Is it part of an ensemble of surviving buildings by Lawrence? No other Lawrence buildings are nearby. Are structural or technical aspects of the design significant? Of little significance.	2 0 0
6. LAWRENCE'S PERSONAL INVOLVEMENT IN THE DESIGN PROCESS: Lawrence was probably chief designer, though little evidence	6
DISTINCTION TOTAL	25

<u>EDUCATIVE OR ASSOCIATIVE VALUE:</u>	
1. HISTORIC EVENTS OR ACTIVITIES: No known association with historic events or activities.	0
2. HISTORIC PERSONS: Strong assoc. with person(s) of state historic significance.	7
3. SYMBOLIC ASSOCIATION WITH AN IDEAL, INSTITUTION, OR POLITICAL ENTITY: No known significant symbolic association.	0
EDUCATIVE OR ASSOCIATIVE TOTAL	7
GRAND TOTAL	48
RANK:	SECONDARY

NOTE: Only the built, surviving buildings in Oregon were evaluated.