

OREGON INVENTORY OF HISTORIC PROPERTY
ELLIS LAWRENCE BUILDING INVENTORY
COUNTY: Tillamook

HISTORIC NAME: TILLAMOOK COUNTY COURTHOUSE

COMMON NAME:	RESOURCE TYPE: Building
OTHER NAMES:	STATUS: built & survives
	<u>LAWRENCE</u>
	(JOB#) YEAR: (1978) 1932
	(JOB#) YEAR: ()
	(JOB#) YEAR: ()
CITY: Tillamook Oregon	FIRST DATE: Oct. 1931
STREET: 201 Laurel Ave.	DESIGN BEG: Febr. 1932
OWNER: Tillamook County	DESIGN END: April 1932
	CONSTR BEG: June 1932
	CONSTR END: Febr. 1933
TOWNSHIP: 01S RANGE: 09W SECTION: 30	LOSS DATE:
MAP#: 01-09-30 TAX LOT: 01-09-30-00-2900	ORIGINAL USE: courthouse
ADDITION:	PRESENT USE: courthouse
BLOCK: LOT: QUAD:	SITE: 1.5 acres, approx.
ASSESSOR #:	
THEMES: 20C Architecture, Local Government	

DATA BELOW IS ON LAWRENCE FIRM'S DESIGN AS-BUILT:

ARCHITECT: Lawrence, Holford, Allyn and Bean CHIEF DESIGNER: probably EFL
ENGINEERS & CONSULTANTS:

CONTRACTORS:

L.H. Hoffman, Portland (general); Grasce Electric, Portland (electric.); George Burckhard, Tillamook (plumbing); C.P. Yundt, Corvallis (heating); English-Baker Co., Portland (lighting fixtures); Roedel Tile Co. (marble, tile, terrazzo).

ARTISTS & CRAFTSMEN:

Lucille Wiley, fresco of the launching of the "Morning Star" (1945)

STYLE: Half Modern

PLAN TYPE/SHAPE: "U"-shaped

FOUNDATION MATERIAL: concrete

STORIES: 2

BASEMENT: yes

ROOF/MATERIAL: essentially flat /Bitum. builtup

WALL CONSTR: concrete

STRUC.FRAME: concrete frame

PRIME WINDOW TYPE: wood multi-pane double-hung w/special round

EXTERIOR SURFACE MATERIAL: brick,

DECORATIVE FEATURES/MATERIALS:

stone columns, name panels, door surrounds and trim at both main entrances;
stone cornice and 2nd-floor head course, & sills; brick decorative patterns.

OTHER:

Additions: rear fire escape; roof radio antenna; roof wire mesh jail exercise area (c. 1985); south basement exit stair; elevator & elev. penthouse (1945).

CONDITION: good

MOVED: not moved

ALTERATIONS/ADDITIONS (dated):

Rear wall of courtroom altered to allow for 2nd flr. passageway (1969); ext. ties added to secure brick facing (c.1970); cast stone coping replaced w/metal.

LANDSCAPE FEATURES:

minimal landscaping, mature shrubs and trees

ELLIS LAWRENCE BUILDING INVENTORY

HISTORIC NAME: TILLAMOOK COUNTY COURTHOUSE

ASSOCIATED STRUCTURES:

SETTING:

urban core, streets on four sides

SIGNIFICANCE OF LAWRENCE FIRM'S DESIGN:

EXTER.DETAILS/CRAFTSMANSHIP: High-quality skilled work: some fine materials.

INTER.DETAILS/CRAFTSMANSHIP: Better than average workmanship and materials.

EXTERIOR INTEGRITY: Essentially intact as originally built.

INTERIOR INTEGRITY: Minor changes, but original character intact.

SITE INTEGRITY: Essentially intact as originally built.

SETTING INTEGR: Historic character & relationship of surroundings is intact.

SIGNIFICANCE STATEMENT:

The Tillamook County Courthouse was built with county funds (no WPA/PWA funds were involved). It is significant for the quality of its design & workmanship. It is built of pinkish-tan brick with chevron & soldier course patterns & restrained stone trim including twin matching entryway panels & columns. The interior has marble floors & wainscoting. The courthouse houses the courtroom, county officials' offices, & jail. This is the only built courthouse designed by Lawrence's firms. Ormond R. Bean and William Holford, partners of Lawrence, were involved with this project; but Lawrence surely played a central role in its design. Bean later became a Portland City Commissioner and influential politician. The building is also significant for its relatively intact quality, especially of the exterior and the most important interior spaces.

SOURCES/DOCUMENTS: Description (Location)

DAILY JOURNAL OF COMMERCE, Portland, 2/1/32 p1, 3/25/32 p1, 4/2/32 p1 & 8, 6/10/32 p1, 7/29/32 p1.

PACIFIC BUILDER & ENGINEER 10/24/31 p2, 12/5/31 p36, 2/6/32 p44, 4/2/32 p44, 4/16/32 p12, 5/21/32 p10, 6/18/32 p11, 12/3/32 p48.

historic photographs & photos of 2 renderings of the building (UO Library, Special Col., EF Lawrence Col.) Exhibit-quality

Ormand R. Bean Papers (Oregon Historic Society, Portland)

complete set of construction plans (Tillamook Co. Courthouse, Surveyor's Off.)

TILLAMOOK HERALD, many articles 1932 to 1933.

PUBLICATIONS:

ARCHITECTURE OREGON STYLE by Rosalind Clark, p.204

SLIDE NO.:

SHPO INVENTORY NO.:

RESEARCH BY: MS / M. Kadas

RECORDED BY: M. Shellenbarger

DATE: 12/07/87

DATE: 12/22/87

ELLIS LAWRENCE BUILDING SURVEY
 HISTORIC NAME: TILLAMOOK COUNTY COURTHOUSE

RECENT PHOTO
 NEGATIVE #s:
 MS2-2

First # above
 is upper-right
 photo; second #
 is just below.
 If no # above,
 see sources at
 bottom of page.

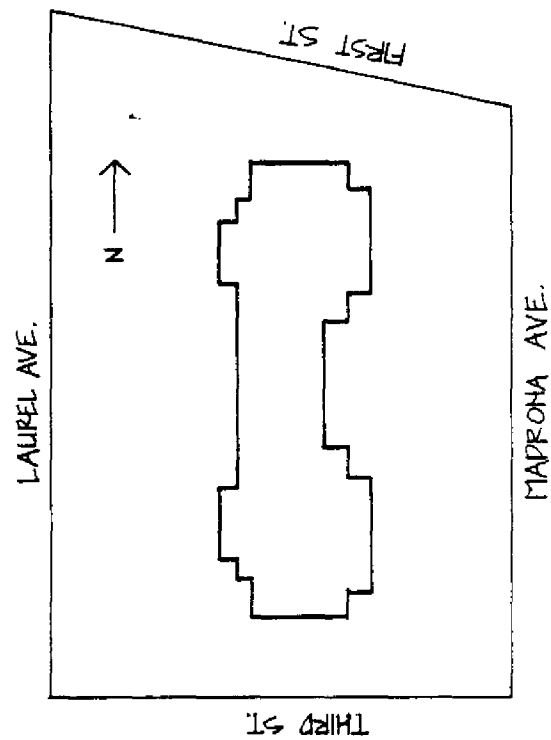
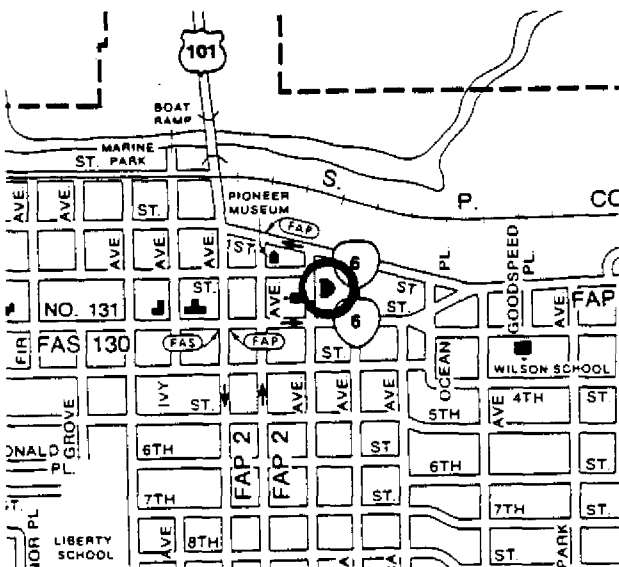

HISTORIC PHOTO/OTHER GRAPHIC SOURCE: Lawrence Col. photos, UO Library

OREGON INVENTORY OF HISTORIC PROPERTY
ELLIS LAWRENCE BUILDING INVENTORY

EVALUATION

HISTORIC NAME: TILLAMOOK COUNTY COURTHOUSE

<u>INTEGRITY OF:</u>	<u>NUMERICAL</u>
1. EXTERIOR: Essentially intact as originally built.	9
2. INTERIOR: Minor changes, but original character intact.	7
3. SITE: Essentially intact as originally built.	9
4. SETTING: Historic character & relationship of surroundings is intact.	5
INTEGRITY TOTAL	30

<u>DISTINCTION OF:</u>	
1. EXTERIOR DETAILS & CRAFTSMANSHIP: High-quality skilled work: some fine materials.	7
2. INTERIOR DETAILS & CRAFTSMANSHIP: Better than average workmanship and materials.	3
3. STYLE: (Half Modern) It is a prime example of its identified style.	5
Compared to Lawrence's other surviving Oregon buildings, this style is unique in its city/town or rural area.	5
4. ORIGINAL USE: (courthouse) Compared to Lawrence's other surviving Oregon buildings, this use is unique in Oregon.	9
5. ARCHITECTURAL DESIGN: Compared to Lawrence's other surviving Oregon buildings, this design is above average quality and significance.	5
Is it part of an ensemble of surviving buildings by Lawrence? No other Lawrence buildings are nearby.	0
Are structural or technical aspects of the design significant? Of little significance.	0
6. LAWRENCE'S PERSONAL INVOLVEMENT IN THE DESIGN PROCESS: Lawrence was probably chief designer, though little evidence	6
DISTINCTION TOTAL	40

<u>EDUCATIVE OR ASSOCIATIVE VALUE:</u>	
1. HISTORIC EVENTS OR ACTIVITIES: Strong association with local historic events or activities.	5
2. HISTORIC PERSONS: Some association with significant historic person(s).	2
3. SYMBOLIC ASSOCIATION WITH AN IDEAL, INSTITUTION, OR POLITICAL ENTITY: Major symbolic association with local ideal or institution.	5
EDUCATIVE OR ASSOCIATIVE TOTAL	12

GRAND TOTAL 82

RANK: PRIMARY

NOTE: Only the built, surviving buildings in Oregon were evaluated.