

HISTORIC RESOURCE SURVEY FORM  
University of Oregon Cultural Resources Survey  
Eugene, Lane County, Oregon  
Summer 2006

RESOURCE IDENTIFICATION

Current building name: Walton (Joshua J.) Hall Complex

Historic building name: Men's Dormitory No.2 (South wing) & No.3 (North wing), 1956 - 1957; George Rebec Hall, Jan. – March 1958.

Building address: North wing: 1593 E. 15<sup>th</sup> Street; South wing: 1595 E. 15<sup>th</sup> Street

Ranking: Non-Contributing

ARCHITECTURAL DESCRIPTION

Architectural style classification: Early Modern

Building plan (footprint shape): H shaped with attached E shaped arms

Number of stories: 4

Foundation material(s): Concrete

Primary exterior wall material: Brick (running bond)

Secondary exterior wall material: Metal (low carbon hot rolled new billet steel), porcelain enamel panels

Roof configuration/type: flat

Primary roof material: unknown

Primary window type: Casement

Primary window material: Metal (low carbon hot rolled new billet steel)

Decorative features and materials: brick pattern work

Landscape features: arcaded interior courtyards with benches, bike racks, and small shrubs and trees

Associated resources: Promenade to the north and 15th Avenue Axis to the south

Comments: The Housing Office moved their office into Walton in 1978, taking over the spaces of five unused dining rooms and part of the kitchen of Walton Hall.

ARCHITECTURAL HISTORY

Date of construction: 1957 - 1959

Architect: Church, Newberry, Roehr, Schuette

Builder/Contractor: J.O. Olsen Mfg. Company & Waldo S. Hardie and Sons (General); Chase Plumbing Company (sheet metal), Portland Wire and Iron (metal roof decks), Lewis Riffel incorporated (misc iron & steel), Atlas Sheet Metal (kitchen equipment), Springfield Glass (glasswork), Builders Insulating & Roofing Company (roofing and waterproofing), Midgleys Mill Work (interior millwork) & Rubenstein Furniture Company (floor covering).

Moved? (yes/no): No Date of move(s): N/A

Description/dates of major additions/alterations: Misc interior repairs: 1977, 1978, 1981, 1982, 1983, 1984, 1985, 1986, 1987, 1988, 2002 & 2003; Re-roofing: 1956, 1968, 1969, 1989, 2003 & 2004; and Outdoor landscape additions: 1958, 1968, 1985, 1987 & 1992.

Currently, there is a proposed future renovation or replacement of the complex to increase occupancy capacity.

HISTORICAL ASSOCIATIONS & SIGNIFICANCE

Original use(s) or function(s): University/Dormitory

Current use(s) or function(s): University/Dormitory

Area(s) of significance: Education, Architecture

Period of significance: 1957 – 1959

Statement of Significance (use continuation sheet if necessary):

Walton Hall was built in the period after WWII in response to effects of the baby boom, which increased student enrollment at the University. It was built along with the Earl (1954-55), Hamilton (1962), and Bean Complexes (1964). The original name of the residence hall was changed from George Rebec Hall to Joshua J. Walton Hall in 1958 after the members of Rebec House protested the use of the same name. Joshua J. Walton was a Eugene city judge and served on the Board of Regents from its inception, from 1872 – 1906.

The design concept of Walton, according to then Housing Director, H.P. Barnhart, was based on the idea of creating small unit living with large unit management. This meant a centralized kitchen, but separate dining halls in each unit; additionally, a recreation room, snack machines and laundry facilities in the basement for the entire complex, but individual lounges in each separate unit. The unit design of Walton also allowed the University to house both men and women in the same complex, but in different units. At one point in time, men were housed in Adams, Clark, DeCou Halls and women in the remaining seven halls. The design concept also included the idea of outdoor living, providing residents with easy access to outdoor patios through sliding glass doors from the lounge areas.

Walton Hall is comprised of ten separate halls, each housing between 60 to 70 students. The south wing was built first in 1957 and consists of, in counter-clockwise direction, Adams, Clark, Douglass, Smith and Sweetser Halls. Adams Hall was named after Percy Paget Adams, a Professor of Graphics from 1901 - 1946 and sometime Assistant and Acting Dean; he was also the responsible architect for Engineering Hall. Clark Hall was named after Dan Elbert Clark, Head of the History Department from 1940 – 1951 and co-founder of *Pacific Historical Review*. Douglass Hall was named after Matthew Hale Douglass, a university librarian from 1908 – 1942. Smith Hall was named for Warren DuPre Smith, Head of the Geology Department from 1914 – 1947. Sweetser Hall was named for Albert Raddin Sweetser, Head of the Botany and later Biology Department from 1902 – 1932 (various dates listed)

The north wing was completed in 1959 and added five units to the complex. It consists of, in clockwise direction, DeCou, Dymont, Hawthorne, McAlister, and Schafer Halls. DeCou Hall was named after Edward DeCou, the head of the Math Department from 1902 – 1939. Dymont Hall was named after Colin Dymont, the Dean of the College of Literature, Science and Arts from 1920 – 1925. Hawthorne Hall was named after Benjamin Hawthorne, Psychology Professor from 1888 – 1909, and who also established the first psychology lab on the Pacific coast. McAlister Hall was named for Edward McAlister, the Dean of the College of Engineering from 1902 – 1925. Schafer Hall was named after Joseph Schafer, the head of the History Department from 1900 – 1920.

Walton Hall Complex is not yet 50 years old, has little significance, and lacks distinction. For the present, despite its excellent integrity, Walton Complex is categorized as a non-contributing campus resource due to its very low significance.

NATIONAL REGISTER ELIGIBILITY ASSESSMENTHistoric Significance (check one):  High  Medium  Low  Very Low or NoneIntegrity (check one):  Excellent  Good  Fair  PoorCondition (check one):  Excellent  Good  Fair  PoorBuilding designation:  City Landmark  National Register  National Historic Landmark  Not listedPreliminary National Register eligibility findingsBuilding is potentially eligible:  Individually or  As a contributing resource in a district only

If eligible individually, applicable criteria (check all that apply):

- A. Associated with significant events  C. Distinctive architecturally  
 B. Associated with significant persons  D. Archaeologically important

If applicable, building qualifies under NR Criterion Considerations:  Yes  No If yes, which apply:Building is NOT eligible:  Intact but lacks distinction or  Altered/loss of integrity or  Not 50 years old

DOCUMENTATION

Indicate resources consulted when researching this building (check all that apply):

- |   |  |  |
|---|--|--|
| <input checked="" type="checkbox"/> University archives | <input checked="" type="checkbox"/> UO Planning Office files | <input checked="" type="checkbox"/> Newspapers           |
| <input type="checkbox"/> Sanborn maps                   | <input type="checkbox"/> Building permits                    | <input type="checkbox"/> SHPO files                      |
| <input type="checkbox"/> State Archives                 | <input type="checkbox"/> State Library                       | <input type="checkbox"/> State Historic Society          |
| <input type="checkbox"/> Local Historic Society         | <input type="checkbox"/> Personal interviews                 | <input checked="" type="checkbox"/> Historic photographs |
| <input type="checkbox"/> Biographical encyclopedias     | <input type="checkbox"/> Obituary indexes                    | Other <u>See below</u>                                   |

BIBLIOGRAPHICAL REFERENCESNewspaper Articles

"5 New Units of Walton Hall." *Daily Emerald* 5 Nov. 1959, 4.

"Dorm now 'Walton'." *Daily Emerald* 7 Mar. 1958, 1.

"Housing Office Makes Its Move to Walton." *Daily Emerald* 23 Jan. 1978, 12.

"Newest Dormitory Addition Set for Completion by Next July." *Daily Emerald* 23 Oct. 1958, 7.

"Oregon's New Dormitory." *Daily Emerald* 7 Aug. 1957, 1.

"What's in a Name?" *Daily Emerald* 20 Jan. 1958, 1.

Original Documents

Alphabetical Subject File, Box 1, "Adams, Percy," Special Collections and University Archives, UO Libraries.

Alphabetical Subject File, Box 1, "Clark, Dan E.," Special Collections and University Archives, UO Libraries.

Alphabetical Subject File, Box 1, "Douglas, M.H.," Special Collections and University Archives, UO Libraries.

Alphabetical Subject File, Box 4, "Smith, Warren D. (Geology), Personalities," Special Collections and University Archives, UO Libraries.

Alphabetical Subject File, Box 4, "Sweetser, Mrs. Albert Raddin," Special Collections and University Archives, UO Libraries.

"Res. Hall History," Office of Marketing, Public Affairs and Assessment, University Housing. (Original documents are from the Special Collections and University Archives).

(see Continuation Sheet 1)

RECORDING INFORMATION

Researched: Erica Steverson and Sarah Helwick, March 13, 2006

Recorded: Susan Johnson and University Planning Office, Summer 2006

Photo number or name: Walton Hall Complex

PHOTOGRAPH



SITE PLAN

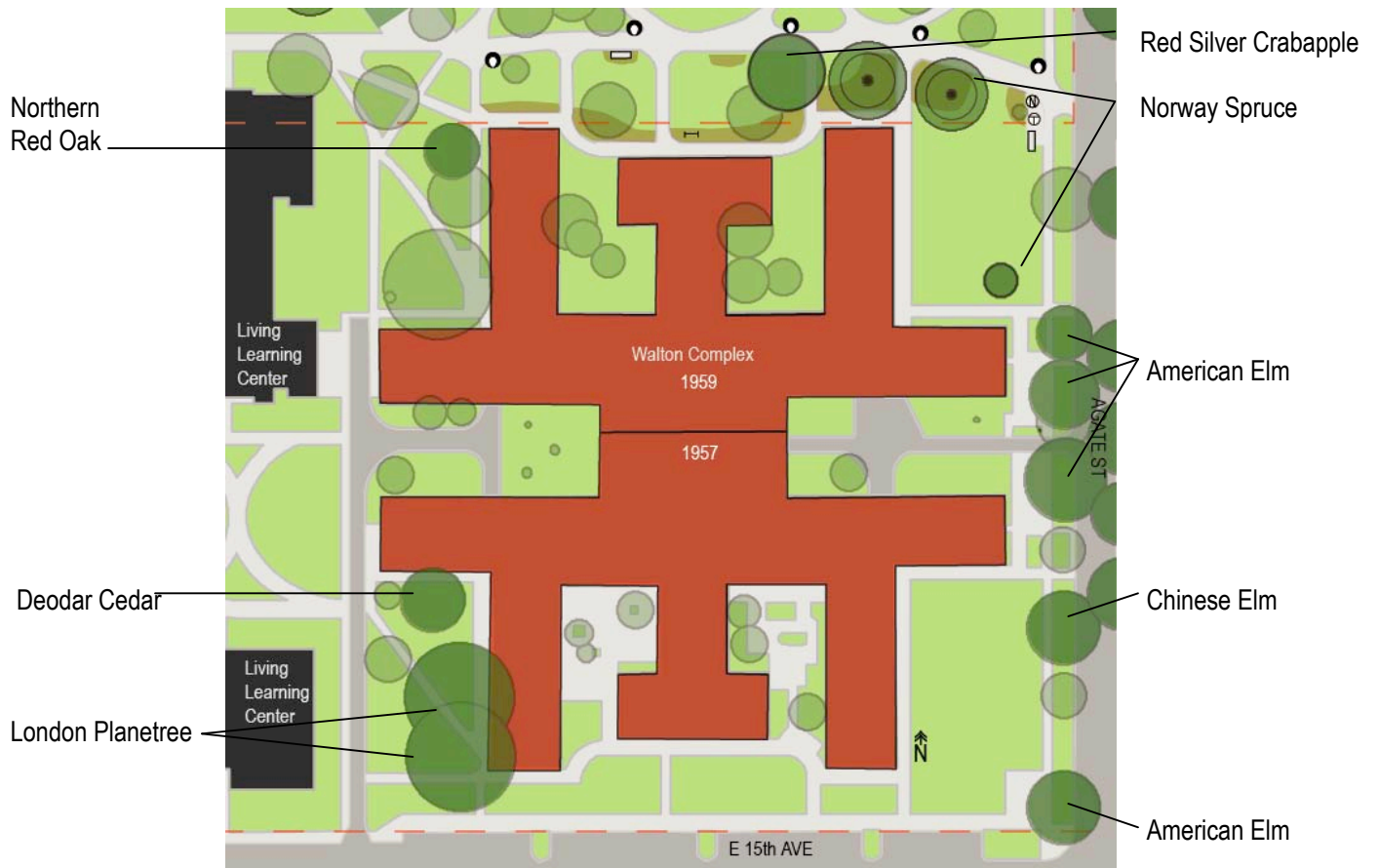

**HISTORIC RESOURCE SURVEY FORM**

University of Oregon Cultural Resources Survey  
Eugene, Lane County, Oregon  
Summer 2006

**Continuation Sheet 1**

Section \_\_\_\_\_ **Bibliographical References** \_\_\_\_\_ Page **3** \_\_\_\_\_

Websites

Oregon State Board of Higher Education Board Budget and Finance Committee June 8, 2001. "Renaming of University Inn to Honor H. P. Barnhart (UO)," available from <http://www.ous.edu/board/dockets/bfddoc010608.htm>; Internet; accessed 19 February 2006.

Teague, Edward H. "Engineering Hall." *The Architecture of the University of Oregon: A History, Bibliography & Research Guide*. University of Oregon Libraries. Available from <http://libweb.uoregon.edu/guides/architecture/oregon/engineering.html>; Internet; accessed 11 March 2006.

Teague, Edward H. "Walton Hall." *The Architecture of the University of Oregon: A History, Bibliography & Research Guide*. University of Oregon Libraries. Available from <http://libweb.uoregon.edu/guides/architecture/oregon/walton.html>; Internet; accessed 18 February 2006.

Thatcher, Edward P. "The Procession of Botanists in Oregon." *Guides to Manuscript Collections*. University of Oregon Libraries. Available from <http://libweb.uoregon.edu/speccoll/guides/botan.html>; Internet; accessed 13 March 2006.

UO Info Graphics Lab, "Campus Maps," available from <http://geography.uoregon.edu/infographics/campusMaps/LineArtMap.pdf>; Internet; accessed 13 March 2006.