



Steve Mortensen
Yost Grube Hall Architects
1211 SW 5th Avenue
Portland,
OR 97204-3782

7 / 13 / 04

Re: OSU College of Engineering

Steve:

I am enclosing a drawing of the revised locations for the kinetic sculptures planned for the atrium of the Kelley Building according to the discussion we had over the phone several weeks ago.

The basic idea is to keep them generally fairly low in the space and have them rise towards the stair landings. The letters on the section designate the individual sails as described in the presentation brochure but given the desire to have them built with a more open weave, the weights and proportions will change somewhat when we get into fabrication. With more space between the individual plates the sails should have slightly larger overall dimensions.

With the winch system, details of which I faxed on 6/17/04, it will be easily possible to make final adjustments of height during the installation. I have indicated the lowest sails to be 13 feet from the finished floor but this might be affected by the ficus trees

Please let me know if you have any questions or further thoughts about placement.

Regards,

Tim Prentice

cc Meagan Attiyeh

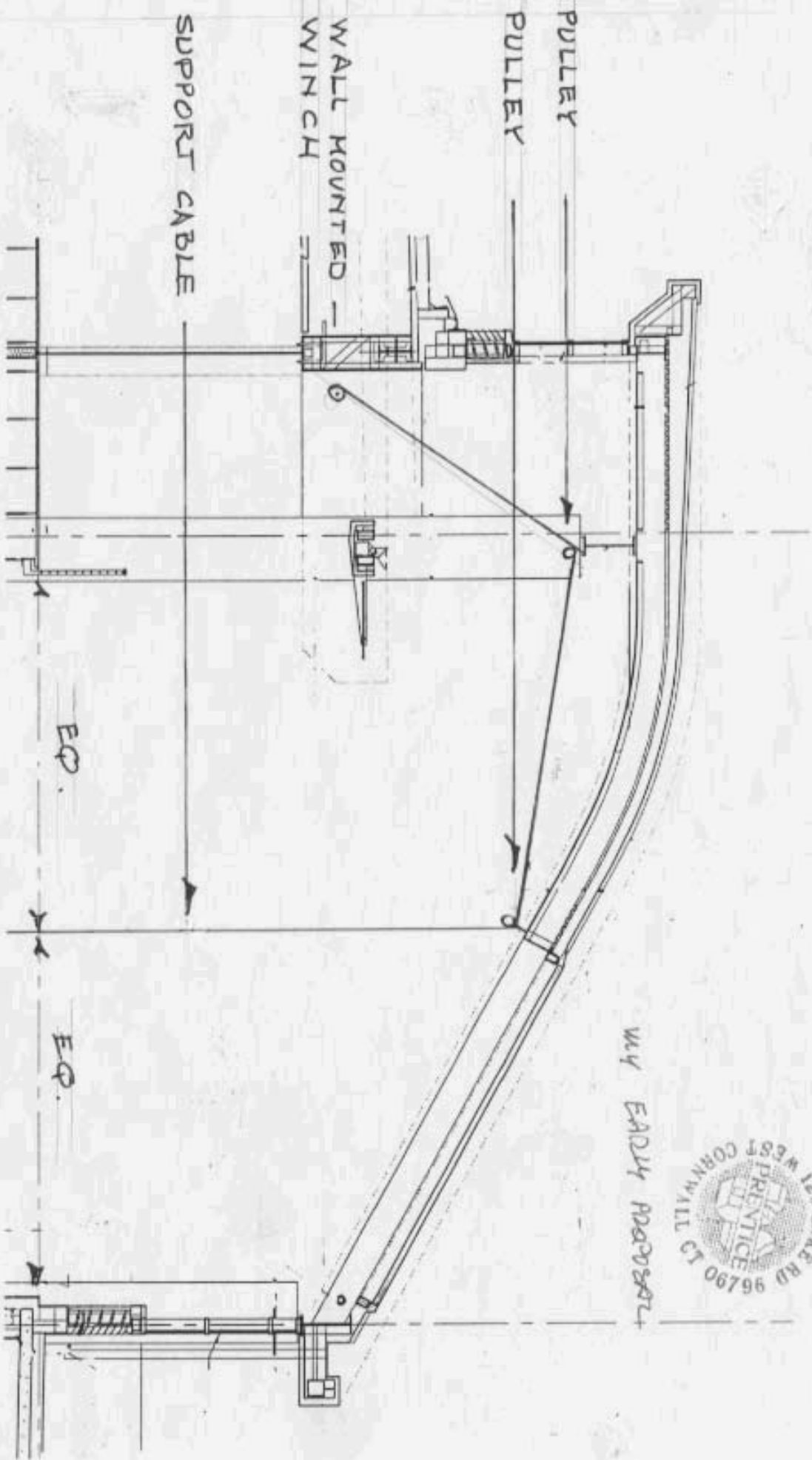

SUSPENSION SYSTEM FOR KINETIC SCULPTURE MAKE THREE
 LOCATE BETWEEN COLUMN LINE 11' 12" 12' 13" 13' 14"
 SECTION SCALE: 3/16"

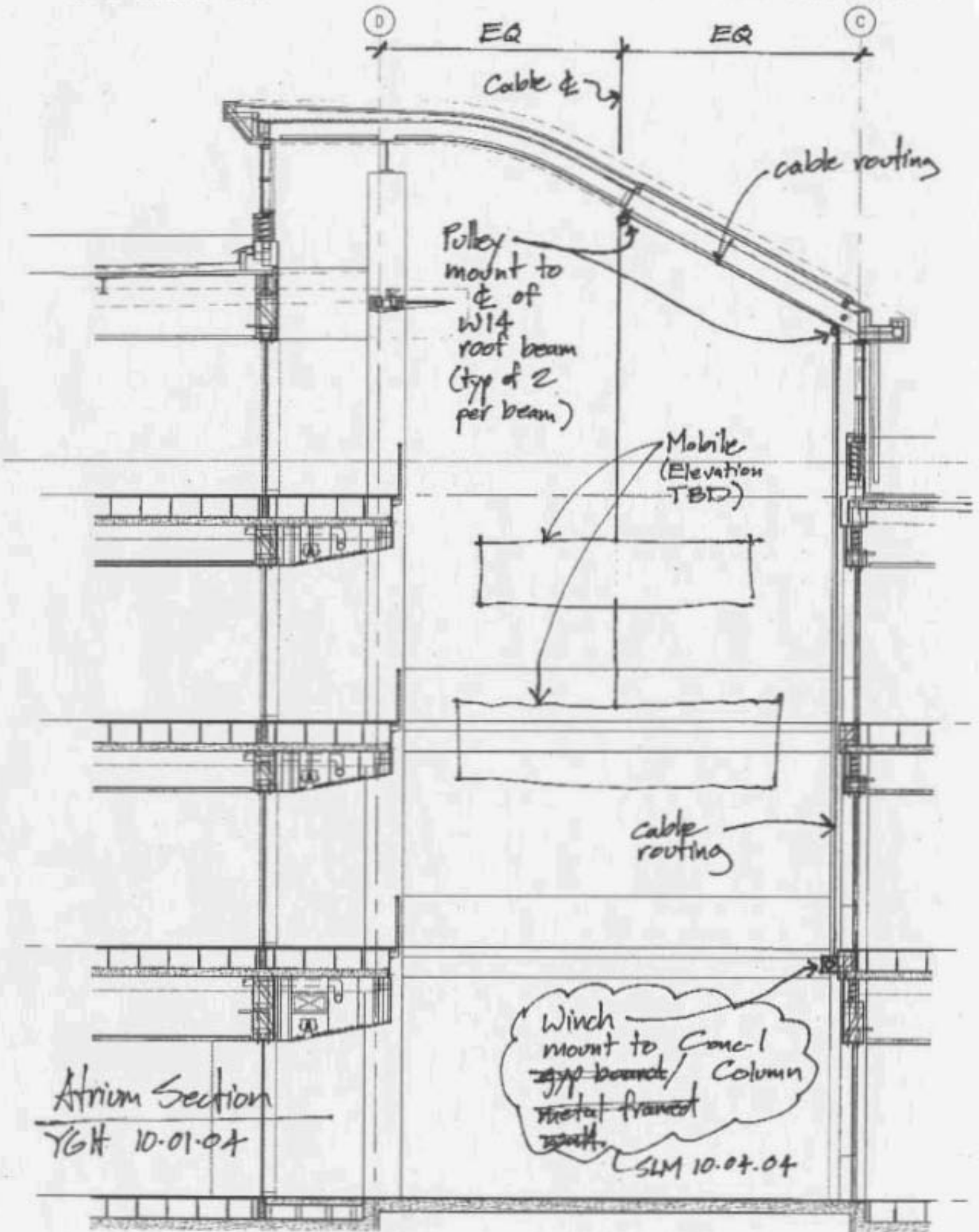

Atrium Section
YGH 10-01-04

SLM 10.04.04