

PLAN OF THE GROUNDS CONNECTED WITH  
 the  
 altar  
 to the  
*Patron of Agriculture*

- A- Altar to the Heaven Gods
- B- " " " Earth "
- C- " " " Sien NUNG
- D- " " " Year God
- E- Depository of the Sacred Vessels
- F- Palace for Congratulation over a fruitful year
- G- Gate entering from EAST.
- H- " " " " "
- I- Paved Roads
- J- Gates one division to another.

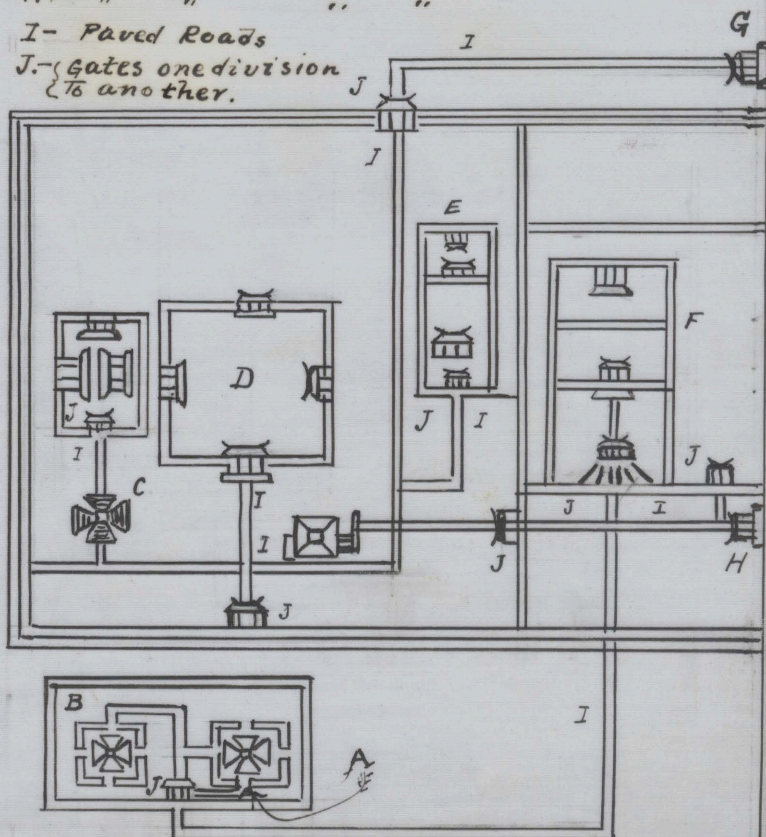

PLAN OF THE GROUNDS CONNECTED WITH  
 the  
 altar  
 to the  
 Patron of Agriculturists

- A - Altar to the Heavens &c
- B - " " " Earth "
- C - " " " Star Vault "
- D - " " " Year God "
- E - Depository of the Sacred Vessels
- F - Palace for congregation over a festival Year
- G - Gate entering from EAST
- H - " " " " "
- I - Paved Roads
- J - Gates one division to another.

