

CFR 1202

Joseph Walton

Oregon Century Farm & Ranch Program Application

Date 4-23-13

Type of designation (please check) Century Farm Century Ranch

Legal owner / Applicant name Joseph Timothy Walton

Farm or Ranch Name JT Walton Ranch

Mailing address of Legal Owner / Applicant Redacted for Privacy

Redacted for Privacy

Telephone Redacted for Privacy

E-mail address Redacted for Privacy

Contact name (if different than legal owner) Melinda Peters

Mailing address of contact Redacted for Privacy

Contact telephone Redacted for Privacy

E-mail address Redacted for Privacy

Location of farm or ranch (which is the subject of this application):

County Grant

Distance 15 miles from nearest town Long Creek

Township 8 S Range 31 Section 17 + 20

Address or physical location of the farm or ranch (which is subject of this application)

Redacted for Privacy

GPS (Global Positioning System) Coordinates, if known _____

Please attach a map or drawing showing the location of the eligible property within the context of the family farm or ranch.

Oregon Century Farm & Ranch Program Application - Continued

Founder(s):

Original family owner(s) or founder(s) Katherine Gaffney Johnson

Date (year) this farm or ranch was acquired by founder(s) 1901
(Attach verifying documentation. See Application Qualification #7)

Who farms or ranches the land today? Joseph Timothy Walton

Relationship of applicant to original owner. Clearly explain lineage from original ownership documents to current applicant. (See Application Qualification #7)

Great Grandson

If the farm or ranch has ever been rented or leased, please explain the owner's role in this relationship. For example, is the owner actively involved in the management of the land?

N/A

History of buildings:

Are any of the original buildings still in use? Yes No House
Barns

When was the first house built? If it is still in use, describe the changes that have been made.

They tore down the original homestead house and rebuilt a new home in 1903.

When was the first barn built? Is it still standing?

The first barn was built in 1904. It is 90% complete.

When were other structures built (examples: silos, machine shops, coops, smokehouses, dryers, etc.). Describe the changes that have been made.

Larger barn in 1911. They also built a tall silo next to the barn. Then silo was chopped off to half its size in later years.

(Continue application on next page)

Oregon Century Farm & Ranch Program Application – Continued

Are any of the buildings listed on the National Register of Historic Places? Yes No
If, "yes", please describe and note the listed name of the property here:

History of crops or livestock raised on farm or ranch:

What were the early crops or livestock?

cows (herefords)
grain / grass hays

How many acres were included in original farm or ranch? 360 acres

How did the crops / livestock / use of farm or ranch change over the years?

As the family expanded the ranch through purchases of surrounding lands, the livestock + feed production increased to it's current rates.

What are crops / livestock raised on the subject farm or ranch today?

cattle
grain hays

How many acres does the subject farm or ranch include today?

~ 10,000

How many acres are in agricultural use today?

~ 10,000

(Continue application on next page)

Oregon Century Farm & Ranch Program Application – Continued

The family:

How many generations live on the farm or ranch today?

One

List names and birth years:

Joseph Timothy Walton - August 1, 1948

Submit two or three pages of family history narrative, including, but not limited to generational transfers of the farm or ranch. Please also submit historical & current photos of the property & family, if available. Digital format photos (at highest resolution [300 dpi]) are particularly desirable, so that they may be used in publications, the CF&R Program Database or the web site. Submitted information, including photos, will be deposited in the OSU Libraries – Special Collections & Archives Research Center for future reference. Please send digital photos included with your application to cfr@oregonfb.org by **May 1**.

Type of information to include in your family history narrative:

- Where founder(s) may have moved from to farm or ranch
- Significant events in the family (births, deaths, marriages, etc.)
- Any major changes to operations (methods of production, etc.)
- Additional information on crops, buildings, other changes from the original farm or ranch

(Continue application on next page)

Oregon Century Farm & Ranch Program
Oregon Agricultural Education Foundation

Statement of Affirmation

I, Joseph Timothy Walton,
hereby affirm and declare that the farm or ranch which I own at Redacted for Privacy
Redacted for Privacy, in the County of Grant

has been owned by my family for at least 100 continuous years, as specified in the qualifications for the Century Farm & Ranch Program, on or before December 31 of the current calendar year. Further, I hereby affirm that this property meets all other requirements for Century Farm or Ranch honors, including that the farm or ranch has a gross income from farming or ranching activities of not less than \$1,000 per year for three out of the five years immediately preceding making this statement. I understand that the application materials will become property of the OSU Libraries – Special Collections & Archives Research Center and be made available for public use. By signing below, I understand that I am consenting to the use of both information and photographs.

Joseph Timothy Walton
Signature of Owner

4-23-13
Date

Certification by Notary Public

Joseph Timothy
State of Oregon County of Grant

Be it remembered, that on this 23 day of April, 2013, before me, the undersigned, a Notary Public in and for said county and state, personally appeared the within named Joseph Timothy Walton, known to me to be the identical individual described in and who executed the within instrument and acknowledged to me that Joseph Timothy Walton executed the same freely and voluntarily.

In Testimony Whereof, I have set my hand and affixed my official seal the day and year last above written.



Jerri A. Bealer
Notary Public for Oregon
My Commission Expires 1-6-2016

Fees

Application Fee (includes one certificate & roadside sign, Note \$50 of this fee is nonrefundable) \$ 250.00
Additional Certificates (\$20 each) \$ -
Additional Signs (\$200 each) \$ 250⁰⁰
Total Enclosed \$ 250⁰⁰

For office use only

Date Received _____
Approved? Yes No
Authorization _____
Oregon Century Farm & Ranch Program Coordinator

Make checks payable to: Oregon Agricultural Education Foundation or OAEF

J.T. Walton Ranch

In 1901, Katherine Gaffney and Felix Johnson purchased a homestead of 360 acres in the beautiful blue mountains near the Middle Fork of the John Day River.

Their son, James (Jimmy) Thomas Johnson who was born on January 16, 1875 in Little Butter Creek, Oregon married Rebecca (Becky) Nancy McCubbin on May 22, 1903.

Becky was born on January 11, 1875, in Shearbridge, Oklahoma to Marietta Young and John McCubbin. She grew up in Lostine, Oregon and attended college in Pendleton, Oregon.

Becky and Jimmy Johnson settled onto the homestead and then purchased it from Jimmy's mom in 1905. They also acquired a 120 acre timber claim and another 160 acre homestead of their own.

They tore down the original house on the property purchased from his mother and built the current main residence, which is still in use today. In 1904, Jimmy and Becky built a barn which was suitable for the operation at that time.

Then in 1911, they built a larger barn with a silo to fit their growing ranch requirements. Both of these barns are still standing today.

After 12 years of marriage, Jimmy and Becky welcomed their only child, Maryette Katherine on July 22, 1915. Due to Becky's advanced age, she traveled 260 miles to Portland, Oregon to deliver their daughter. Throughout the years, they continued to raise Hereford cattle and produced their own feed of grass hay and grain hay.

The young redheaded Katherine met Jesse (Bud) Francis Walton through the small community of Catholics in the Long Creek area. He was the son of the local store owners, Cleveland and Agnes Walton. He was born on January 22, 1916, in Fox, Oregon on a negative 20 degree day. He weighed over 11 pounds according to the store scales.

Bud worked on his grandfather's ranch in Butter Creek, Oregon and his dad's ranch in Ritter, Oregon until he married his Irish redhead on October 10, 1936. They made their home on the Johnson Ranch.

As the years passed, Bud and Katherine increased the acreage of the ranch. They purchased some of the land for a mere \$3.00 per acre. Eventually, the ranch became known as the Walton Ranch.

Bud and Katherine had four children. James Cleveland Walton was their eldest son, born on July 7, 1937. He became a successful attorney and set up his practice in Pendleton, Oregon. He died tragically at a young age of 38 on February 5, 1976. He had four children.

On April 22, 1941, their only daughter was born, Nancy Frances Walton Carey. She also moved to the town of Pendleton, Oregon. She had a career as a Licensed Practical Nurse (LPN). On July 19, 1990, she lost her battle with cancer leaving her legacy of four children.

The third child of Bud and Katherine was born on September 5, 1945, Paul Dean Walton. He had four children. For many years, Paul ranched with his father and younger brother. He currently continues to ranch on his part of the ranch he inherited with his eldest son, James Paul Walton.

Bud and Katherine's youngest child, Joseph Timothy Walton, was born on August 1, 1948. He married Patricia Ann Davis of Pendleton, Oregon at the St. Mary's Catholic Church on August 19, 1972. They moved to the ranch and made their home in the very house that Jimmy and Becky built in 1903. Joseph and Patricia had three daughters, Rebecca Mary Walton Johnson of Albany, Oregon, Jennifer Lynn Walton Fecht of Lovelock, Nevada, and Melinda Fay Walton Peters

of Richland, Washington. The three daughters have blessed Joseph and Patricia so far with five grandchildren, who love visiting the ranch.

With the exception of his education and honorable service in the Vietnam War, Joseph has lived his entire life on the family ranch. Continuing in the history and traditions set down in the past by his parents and grandparents before him. With the passing of his father Jesse Francis Walton on March 5, 2005, Joseph has strived to embrace his stewardship of the land, timber, and cattle that he will pass on to the generations to follow.

Know all men by these presents,
That Lena M. Gerking in consider-
ation of the sum of One Thousand Dollars
to her paid by Kate Johnson, has bar-
gained and sold, and by these presents
does hereby grant, bargain, sell and
convey to said Kate Johnson and to
her heirs and assigns forever, the
parcel of real estate situate, lying and
being in Grant County, State of Oregon, and
bounded and particularly described
as follows, to-wit:-

The North West quarter of the South west
quarter of Section 17, in Township 8, South
of Range 31 East Willamette Meridian;

Also the East half of the South west
quarter and the South half of the North west
quarter of Section 17, in Township
8 South, of Range 31, East Willamette
meridian;

Also the South half of the South East
quarter of Section 17, and the North half
of the North East quarter of Section 20,
in Township 8 South of Range 31, East
Willamette Meridian, containing 360 acres,

Together with the tenements,
hereditaments and appurtenances
thereto belonging, or in any wise
appertaining; also all her estate,
right, title and interest, at law
and equity, thence or thence, inclu-
ding dower and right of dower.

Do have and to hold the same to
the said Kate Johnson, and to her
heirs and assigns forever. And Lena
M. Gerking does covenant with the said
Kate Johnson and her heirs, assigns
and legal representatives forever, that the
said real estate is bona fide in her
possession and that she, the owner in fact,
simple has a good right to sell and

convey the same, and that she will and her heirs, executors and administrators shall warrant and defend the same to the said Kate Johnson and to her heirs and assigns forever, against the lawful claims and demands of all persons whomsoever.

In Witness Whereof, I have hereunto set my hand and seal this 11th day of May, A.D. 1901.

Executed in presence of
James D. Johnson
Chas W. Coe

Lena M. Gerking

Revenue Stamp
\$1.00 cancelled

State of Oregon } ss.
County of Grant }

This certifies that on this, the 11th day of May A.D. 1901, before me, the undersigned a Notary Public in and for said County and State, personally appeared the within named Lena M. Gerking, to me known to be the identical person, described in and who executed the within instrument, and acknowledged to me that she executed the same freely and voluntarily for the uses and purposes therein mentioned.

In Testimony Whereof, I have hereunto set my hand and official seal this day and year last above written.

Official Seal

Charles H. Coe
Notary Public
for Oregon.

Recd for Record May. 13th 1901.

No. 3990. Kate Johnson. To. J.T. Johnson.

Know all men by these presents, That I, Kate Johnson a single woman of Heppner County of Morrow State of Oregon, in consideration of One Dollars to me paid by J.T. Johnson of Heppner County of Morrow State of Oregon, ha---bargained and sold and by these presents do bargain, sell and convey unto said J.T. Johnson his heirs and assigns all the following bounded and described real property, situated in the County of Grant and State of Oregon, to-wit:

N W 1/4 of SW 1/4 Section 17; E 1/2 of SW 1/4, S 1/2 of NW 1/4, S 1/2 of SE 1/4 Section 17 and N 1/2 of NE 1/4 of Section 20 All in Tp 8 S.R. S.R. 31 E.W.M. Containing 360 acres .

together with all and singular the tenements, hereditaments and appurtenances thereto belonging or in anywise appertaining, and also all my estate, right, title and interest in and to the same, including dower and claim of dower.

To Have And To Hold, the above described and granted premises unto the said J.T. Johnson his heirs and assigns forever. And I, Kate Johnson grantor above named do covenant to and with J.T. Johnson the above named grantee his heirs and assigns, that the above granted premises are free from all incumbrances and that I will and my heirs, executors and administrators, shall warrant and forever defend the above granted premises, and every part and parcel thereof, against the lawful claims and demands of all persons whomsoever.

In Witness Whereof, I the grantor above named, hereunto set my hand and seal this 28th day of February A.D. 1905.

Signed, sealed and delivered in the presence of us as witnesses: C.E. Woodson. Geo J. Currin.

Kate Johnson.

(SEAL)

State of Oregon, County of Morrow, SS.

This certifies-- certifies, that on this 28th day of February A.D. 1905, before me, the undersigned, a Notary Public in and for said County and State, personally appeared the within named KATE Johnson known to me to be the identical person described in and who executed the within instrument, and acknowledged to me that she executed the same freely and voluntarily for the uses and purposes therein mentioned.

In Testimony Whereof, I have hereunto set my hand and official seal the day and year last above written.

(SEAL)

C.E. Woodson, Notary Public for Oregon.

Received for Record June 11th, 1906. At 8-A.M.

No. 3992. Edward J. Flaherty. To. Werner Broberg.

This Indenture, Made this 31st day of May A.D. 1906 between Edward J. Flaherty (A Bachelor) party of the first part, and Werner Broberg party of the second part, Witnesseth, That the said party of the first part, for and in consideration of the sum of Twelve Hundred Dollars, to him in hand paid by the said party of the second part the receipt whereof is hereby acknowledged, do hereby grant, bargain, sell and convey, unto the said party of the second part his heirs and assigns forever, all that tract or parcel of land, lying and being in the County of Grant and State of Oregon, and described as follows, to-wit:

The South East quarter of the North East quarter of Section One in Township Ten South of Range Thirty One East and the Lot Numbered Three and Five and the South East quarter of the North west quarter of section Six in Township Ten, South of Range Thirty Two East of Willamette Meridian in Oregon, Containing One Hundred and Sixty one acres and Eighty nine hundredths of an acre.

To Have And To Hold the Same, together with all the hereditaments and appurtenances thereunto belonging, or in anywise appertaining, to the said party of the second part, his heirs and assigns forever. And the said Edward J. Flaherty, party of the first part, for his heirs, executors and administrators, do covenant with the said party of the second part, his heirs and assigns, that he is well seized in fee of the land and premises aforesaid; and has good right to sell and convey the same in manner and form aforesaid; that the same are free from all incumbrances.

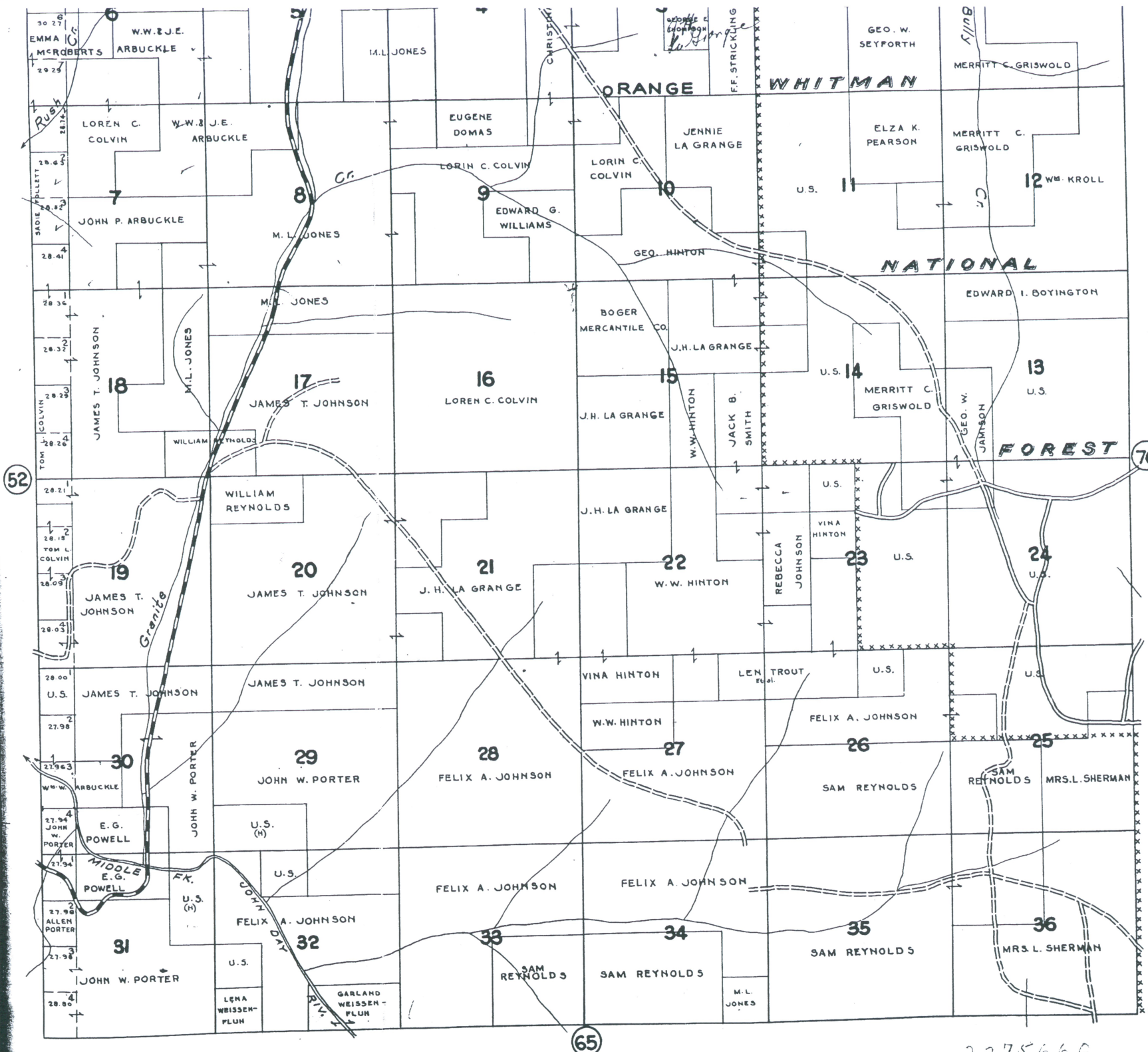

Township 8 S.
Range 31 E.

1935
Met

—LEG
PAVED ROADS
STATE HIGHW.
GRAVELED ROAD
DIRT ROADS
INFERIOR RO
RAILROADS
TRAILS
INTERMITT
SCHOOLS
HOMESTEAD

2275660

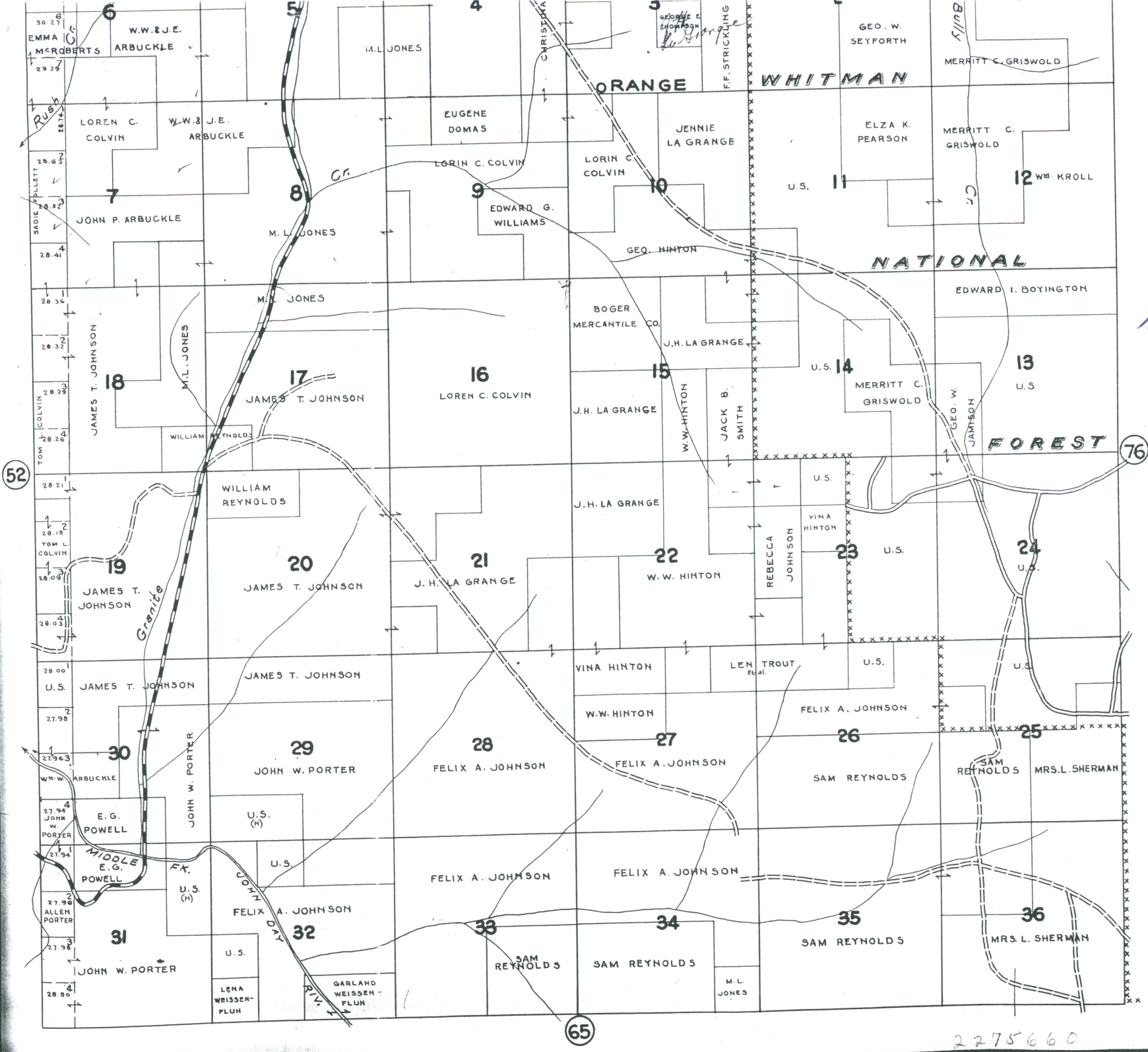

Township 8 S.
Range 31 E. W.M

1935
Metsker's Atlas

- LEGEND-**
- PAVED ROADS
 - STATE HIGHWAYS
 - GRAVELED ROADS
 - DIRT ROADS
 - INFERIOR ROADS
 - RAILROADS
 - TRAILS
 - INTERMITTENT CREEK
 - SCHOOLS
 - HOMESTEADED NOT

2275660



















Picture of "Hone"









